

GL-BL30 / BL50 Series

User's Manual

Thank you for choosing the GL-BL30 / BL50 Series LED products. Please install and use the products according to the following directions to ensure normal function and operation. If you do not follow these instructions to properly install and use the GL-BL30 / BL50 Series, you will not be eligible for warranty compensation or protection. We do not take any responsibility for product damage resulting from improper installation or abnormal usage.

* For 3 in 1 dimmable function

- "DIM+ / DIM-" Connecting a variable resistor (10K~100K resistor) / 1~10Vdc Direct Voltage or a 10V / PWM signal can adjust the dimmable lighting.
- Connecting "DIM+ / DIM-" to "AC L / AC N" may damage the Lighting.
- When the control cable "DIM+ / DIM-" is open, LED Light output is 100%.
- The 3 in 1 Dimmer is not capable of turning off the LED light completely. To turn off the light, we would recommend you to use the dimmer with a switch.

For detailed 3 in 1 dimmable function description, please visit the web site: <http://www.glaciallight.com/products/PDF/3in1Dimming-Function.pdf>



Installation Steps

Step 1.

Use four M4 x 12 mm screws to secure the light-shade and ring to the fixture with a Phillips screwdriver.

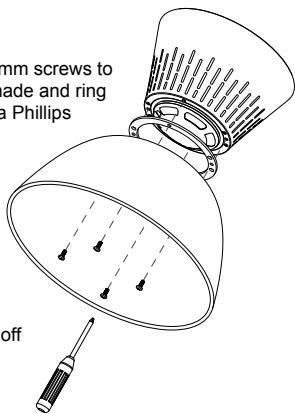

Make sure to turn off the power before installing.

Step 2.

Remove screw nuts from the ceiling mount.

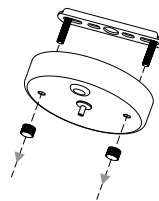

Step 3.

Screw the mounting plate on the ceiling.

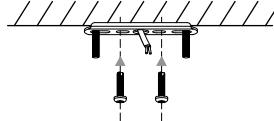

Step 4.

Make the wire and the suspension cable through the ceiling mount.

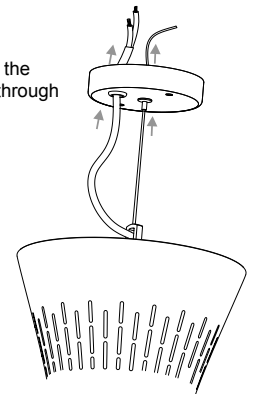

Step 5.

For non-dimmable

Properly insert Line (L) and Neutral (N) into the AC power connector.

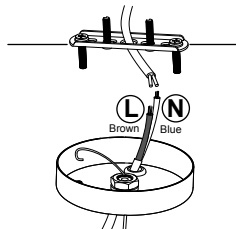

Step 6.

Adjust the length of the wire and suspension cable according to demand. Make the ceiling mount through the screws of the mounting plate and fix the screw nuts.

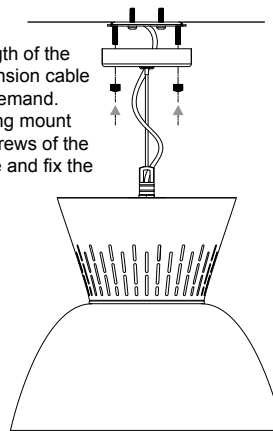

Step 7.

Installation completed.

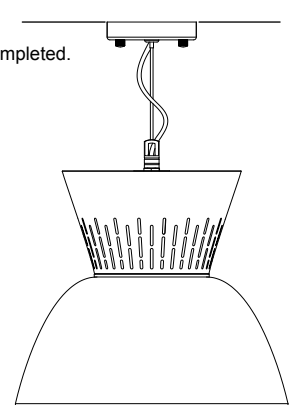

* For 3 in 1 dimmable

- (1) Properly insert Line (L) and Neutral (N) into the AC power connector.
- (2) Connect the Dimmable cord with the Lamp lines DIM+ / DIM-.

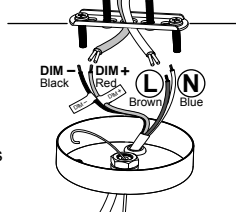

* Connecting "DIM+ / DIM-" to "AC L / AC N" may damage the Lighting.

GL-BL30 / BL50 Outlook

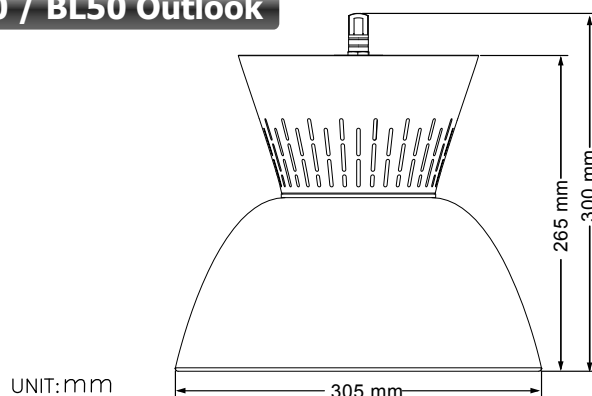

CAUTIONS

1. If the external flexible cable or cord of this luminaire is damaged, it shall be exclusively replaced by the manufacturer or his service agent or a similar qualified person in order to avoid a hazard.
2. Prior to installation, remove the AC power.

BR



GL-BL30 / BL50 系列 使用手冊

感謝您選擇使用GL-BL30 / BL50系列LED燈具。請您依據下列說明指示來安裝本產品以確保本產品的正常運作。如您未按說明指示妥善安裝以及正常使用，您的產品將無法得到正常的保修補償。不正常的安裝與使用所造成的產品損壞，本公司具免責權利。

* 3合1調光功能說明

- 在DIM + 和DIM - 之間連接一個可變電阻(10K~100K resistor)或連接1~10Vdc直流電壓或10V / PWM信號，可調整亮度。
- 勿將DIM + / DIM - 與AC L / AC N相連接，這樣會造成LED驅動器損壞。
- 當控制線DIM + / DIM - 開路(open)時，亮度輸出為100%。
- 3合1調光驅動器不能將LED照明完全關閉(0%)，要達到LED照明完全關閉(0%)建議使用含有開關(SW)的調光器。

相關詳細3合1調光功能說明，請至：<http://www.glaciallight.com/products/PDF/3in1Dimming-Function.pdf>



安裝指南

步驟 1.

使用四個M4×12 mm螺絲將燈罩與光環夾緊固定，用十字螺絲起子鎖緊。



安裝前，請確實關閉電源。

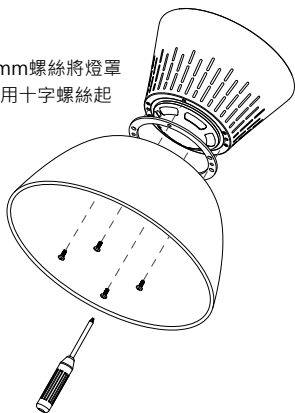

步驟 2.

取下吸頂配件螺絲。

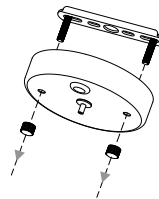

步驟 3.

將吸頂掛板鎖在天花板上。

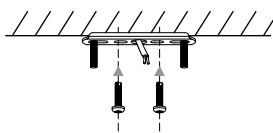

步驟 4.

將鋼繩及電源線穿過吸頂盤。

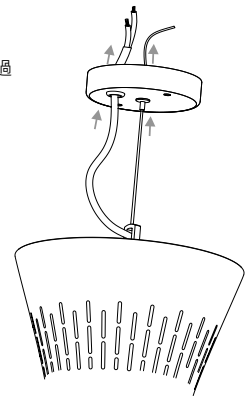

步驟 5.

無調光功能

連接電源線到電源驅動器 L / N

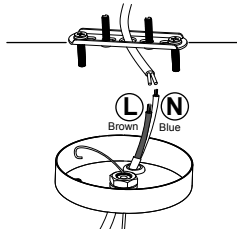

步驟 6.

將吸頂盤穿過掛板螺絲，並將螺帽鎖上。
將鋼繩及電源線作固定。

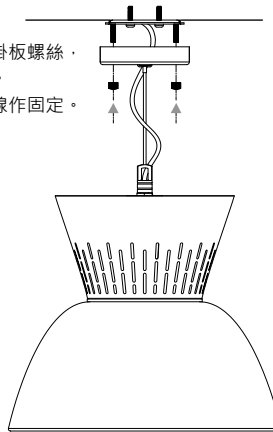

步驟 7.

安裝完成。

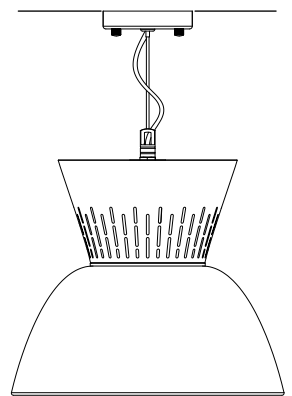

* 3合1調光功能

- (1) 將L / N正確連接到AC電源。
- (2) 將調光線與燈具的DIM+ / DIM- 線，相連接。

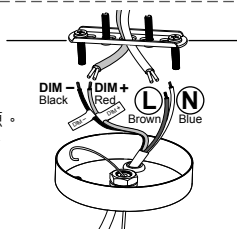

* 勿將DIM + / DIM - 與AC L / AC N相連接，這樣會造成LED驅動器損壞。

GL-BL30 / BL50 外觀

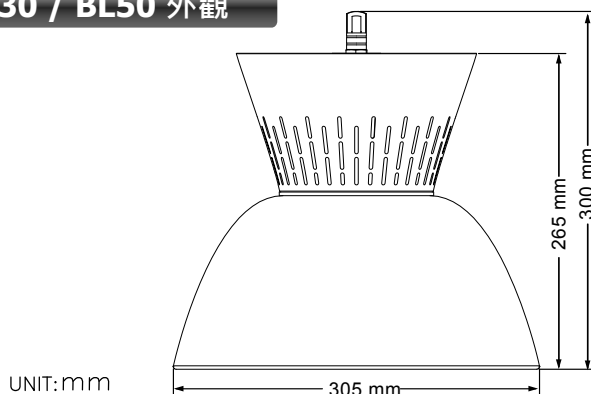

警告

1. 如果燈具外部纜線有損壞，應當由製造商、代理商或符合資格的施工人員做更換，以避免危險。
2. 安裝前，請確實關閉交流電源。

BR

CE FC IP65

